

GATES (MAZE GARDEN)

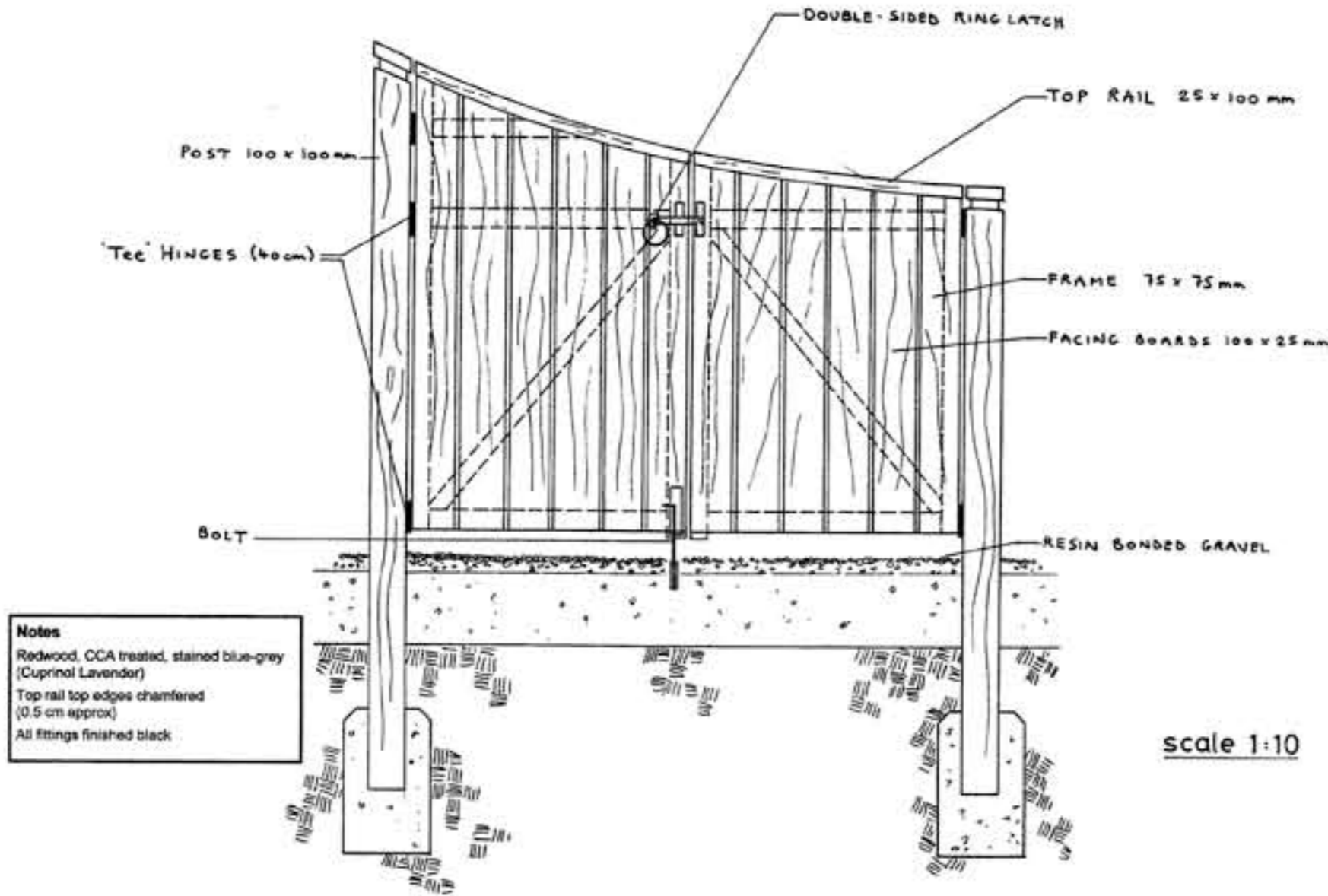

BOUNDARY WALL AND FENCE

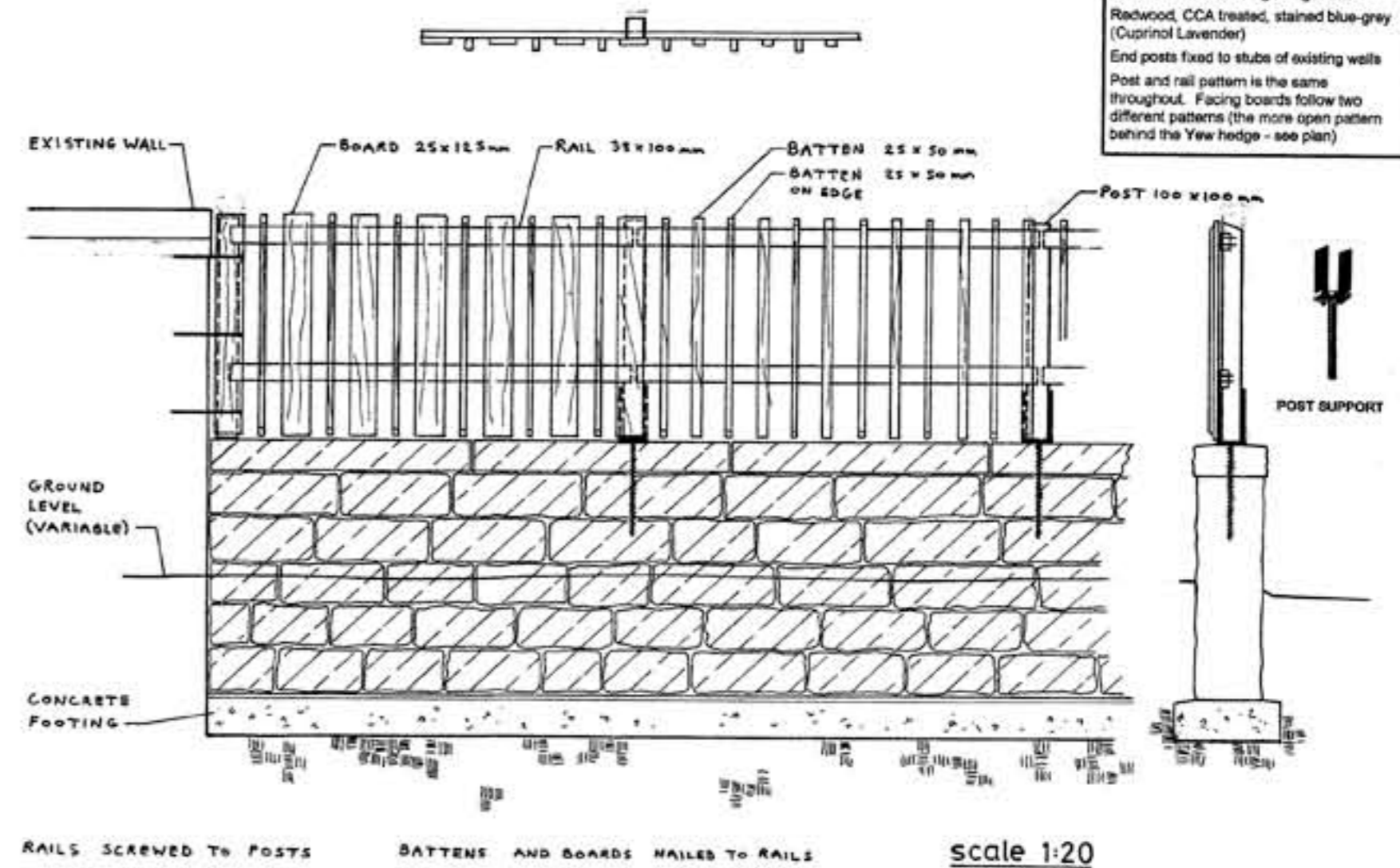

CANAL

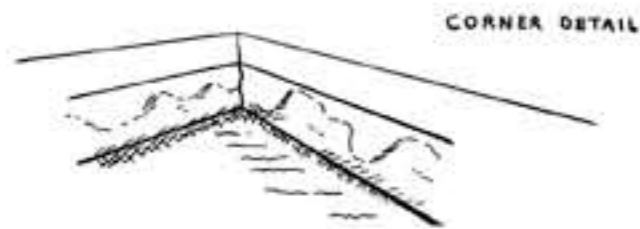

CORNER DETAIL

scale 1:20

Notes
Pool Surround
 Pre-cast, pre-coloured concrete slabs with one face moulded to give rough-hewn appearance 2.1 x 0.5 x 0.145 m (Slabs laid with moulded edge facing into pool.)
 Corners are mitred
 Supplier: Brand and Rice 01334 652826
Pump
 Titan 2000
 Power supply cable follows line of water pipe behind slate wall, connects to switch/fuse-box in conservatory

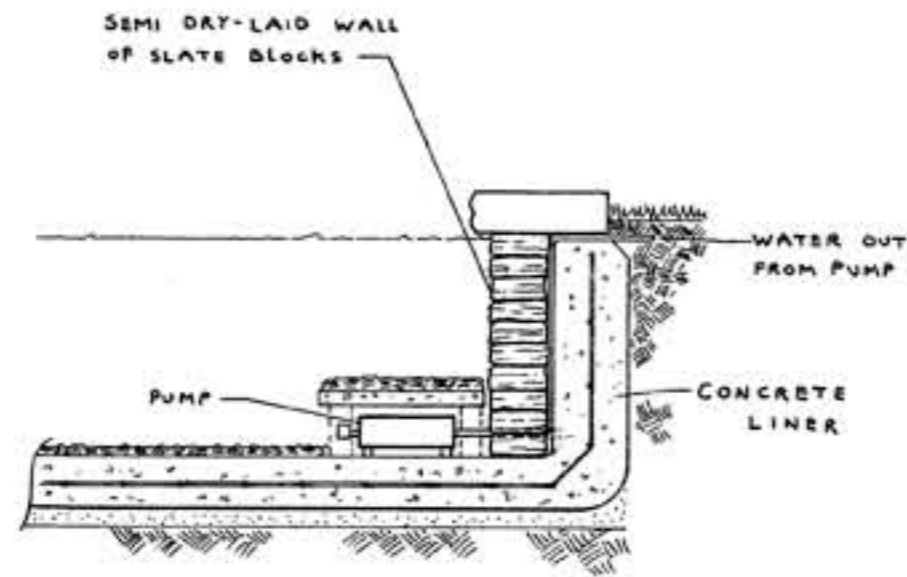
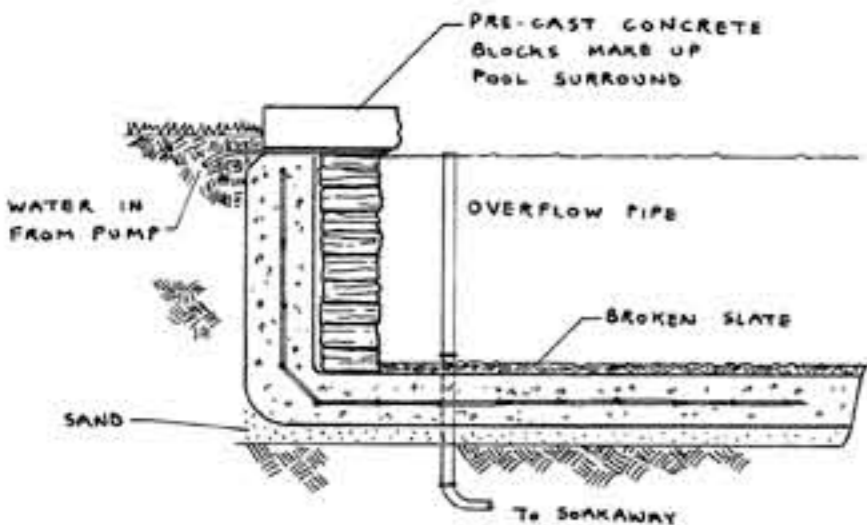

BUILT-IN BENCHES

scale 1:10

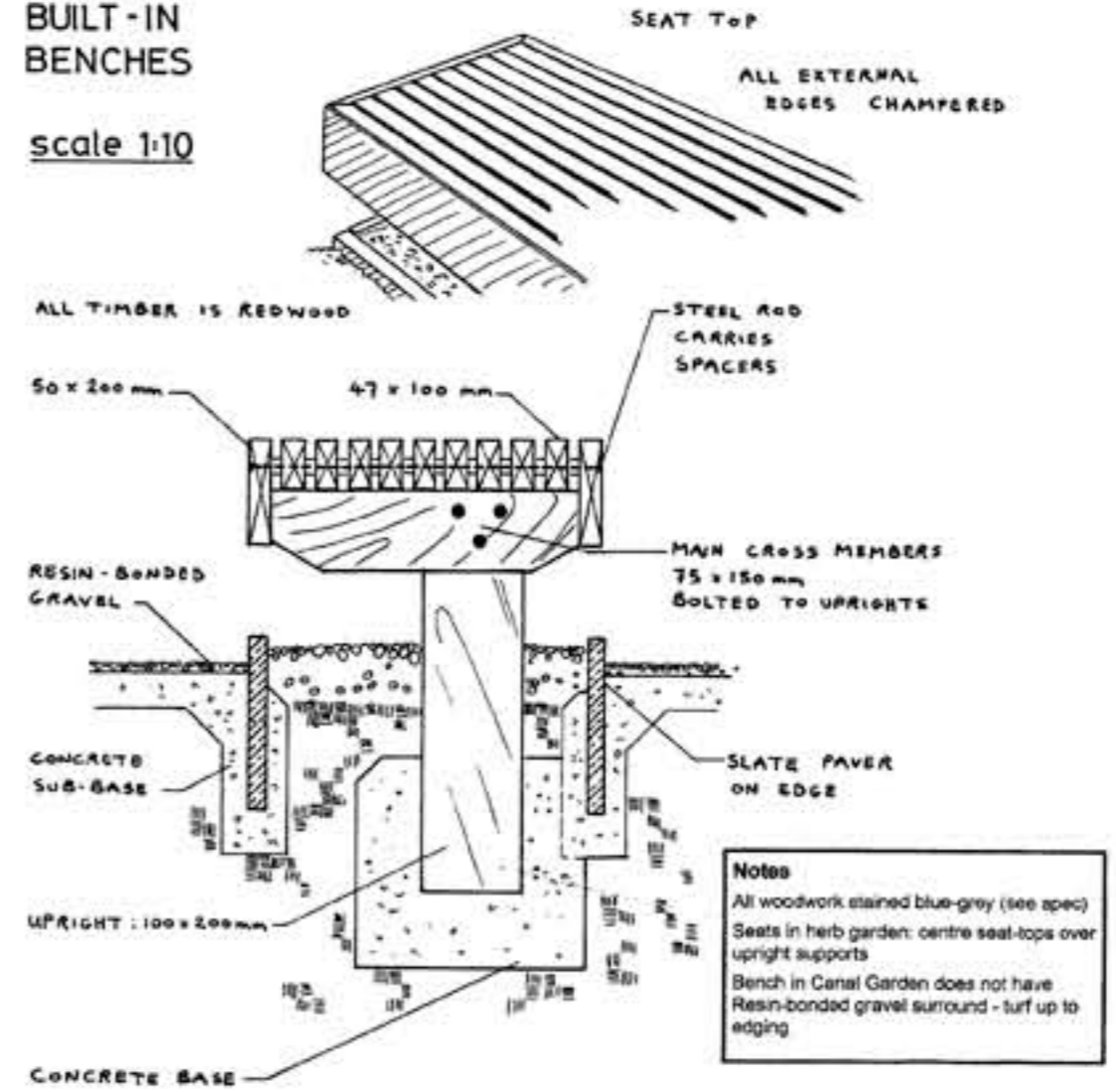

MAZE GARDEN: HEDGE PROFILES

scale 1:50

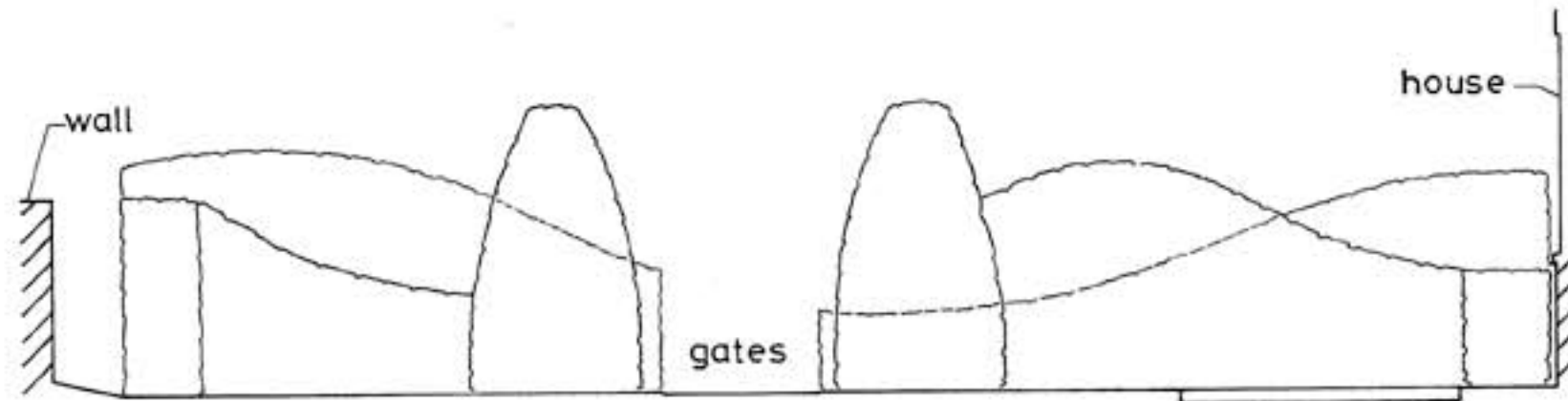

TERRACE: BOX BALLS AND 'EMERGING' CUBES

scale 1:20

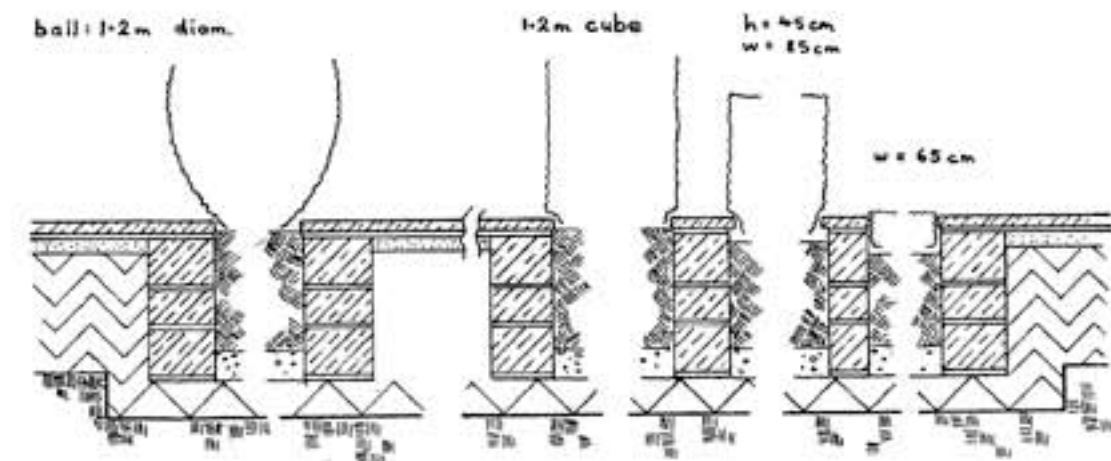

PERGOLA

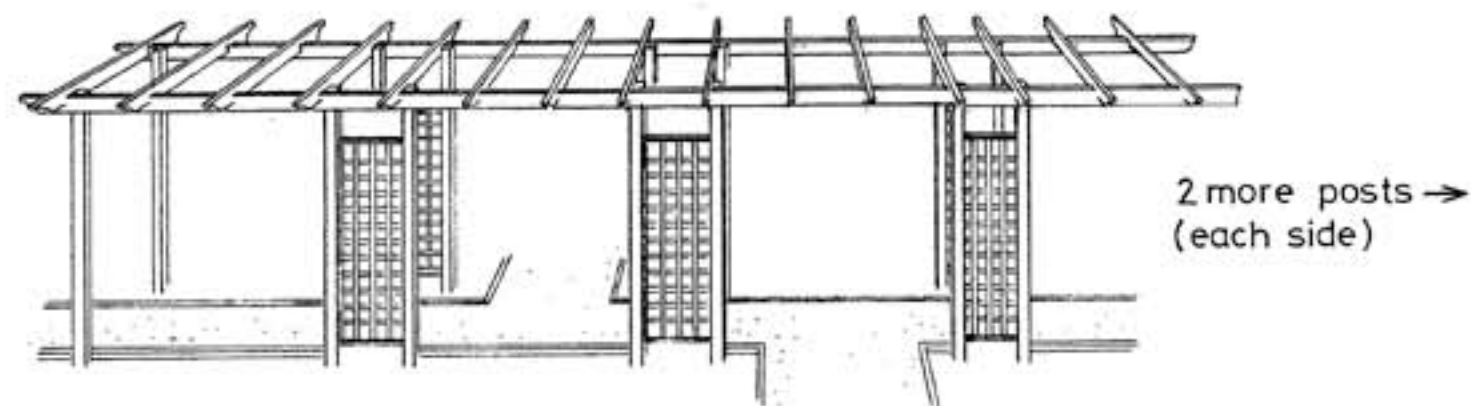

NB Position of trellis panels

HERB GARDEN: Posts and Trellis Panels

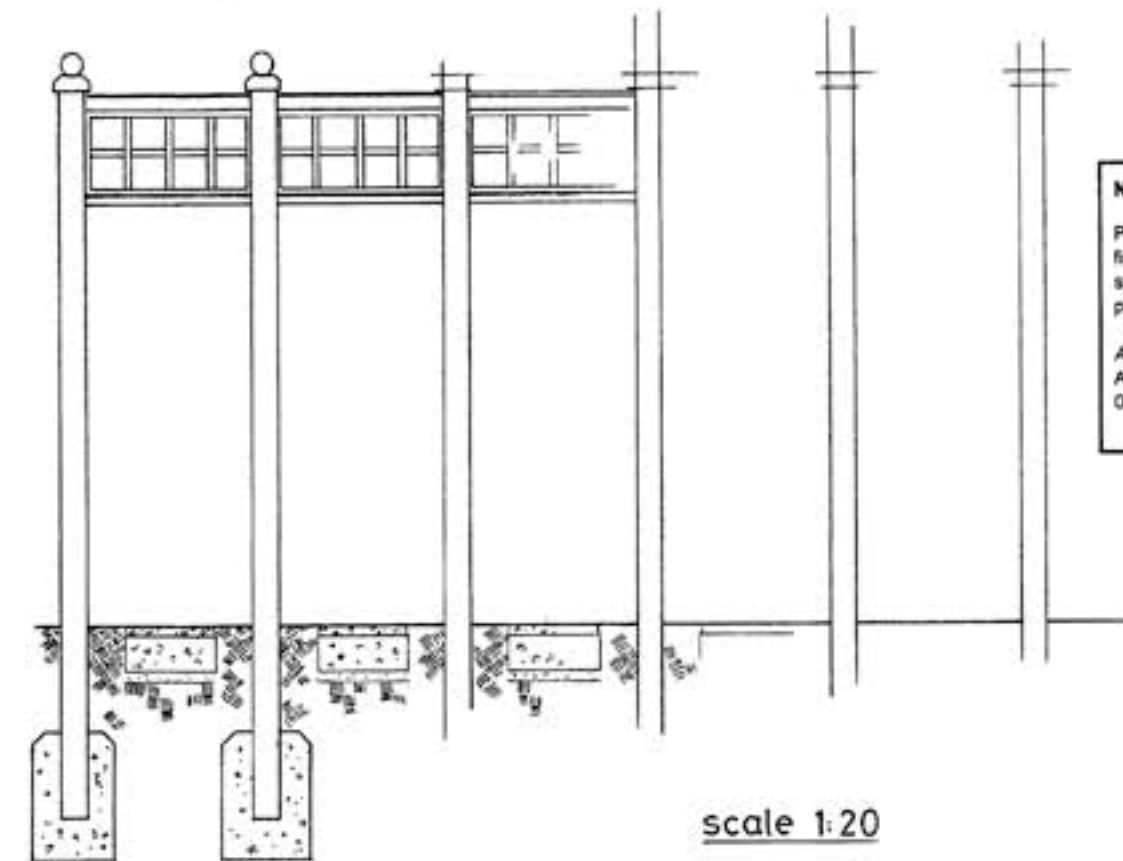

Notes
 Plain square posts with ball finials on flat cap and standard square trellis panels
 All components from:
 Anthony de Grey
 0171 738 8866

scale 1:20

Climbers

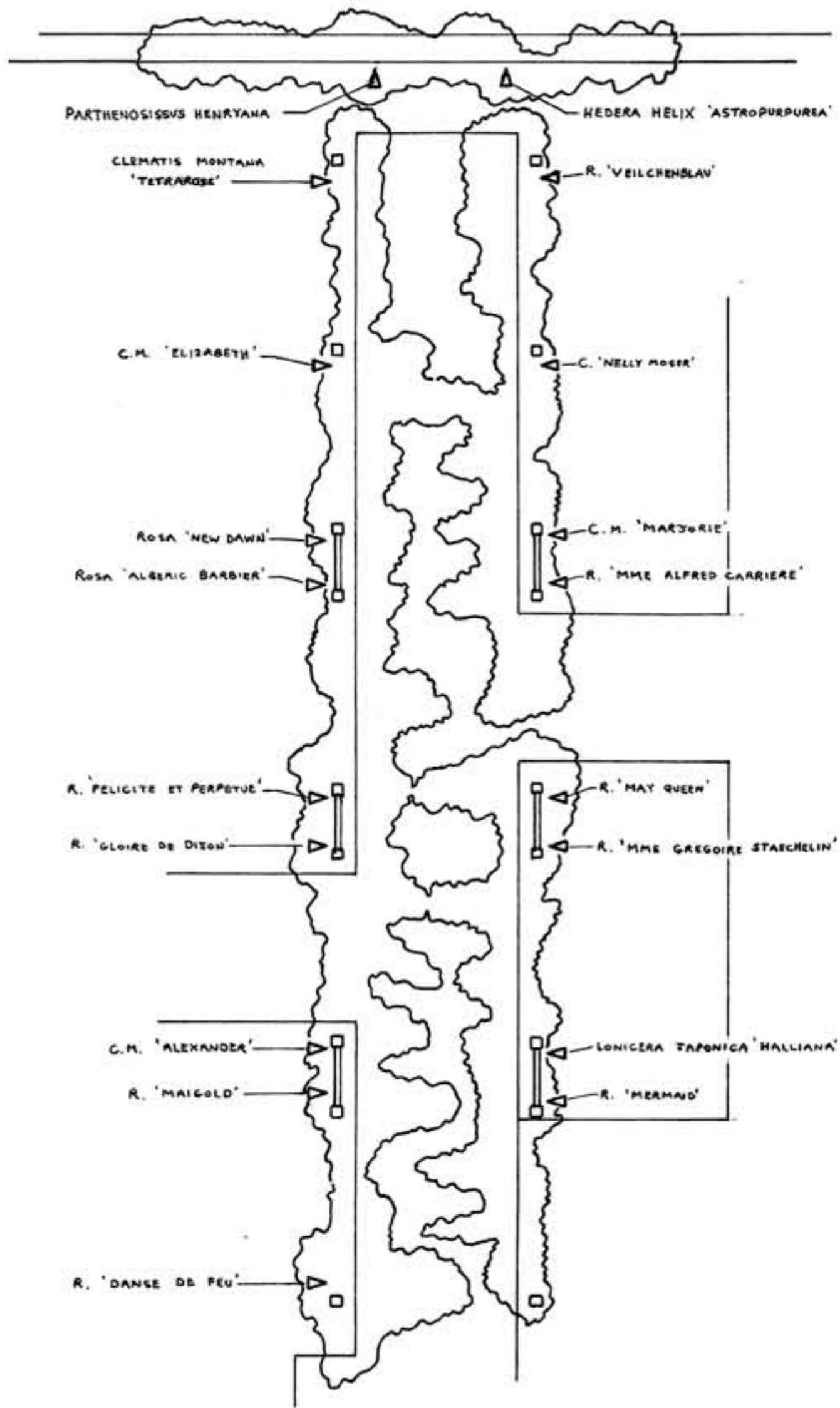

PERGOLA PLANTING

Surrounding Planting

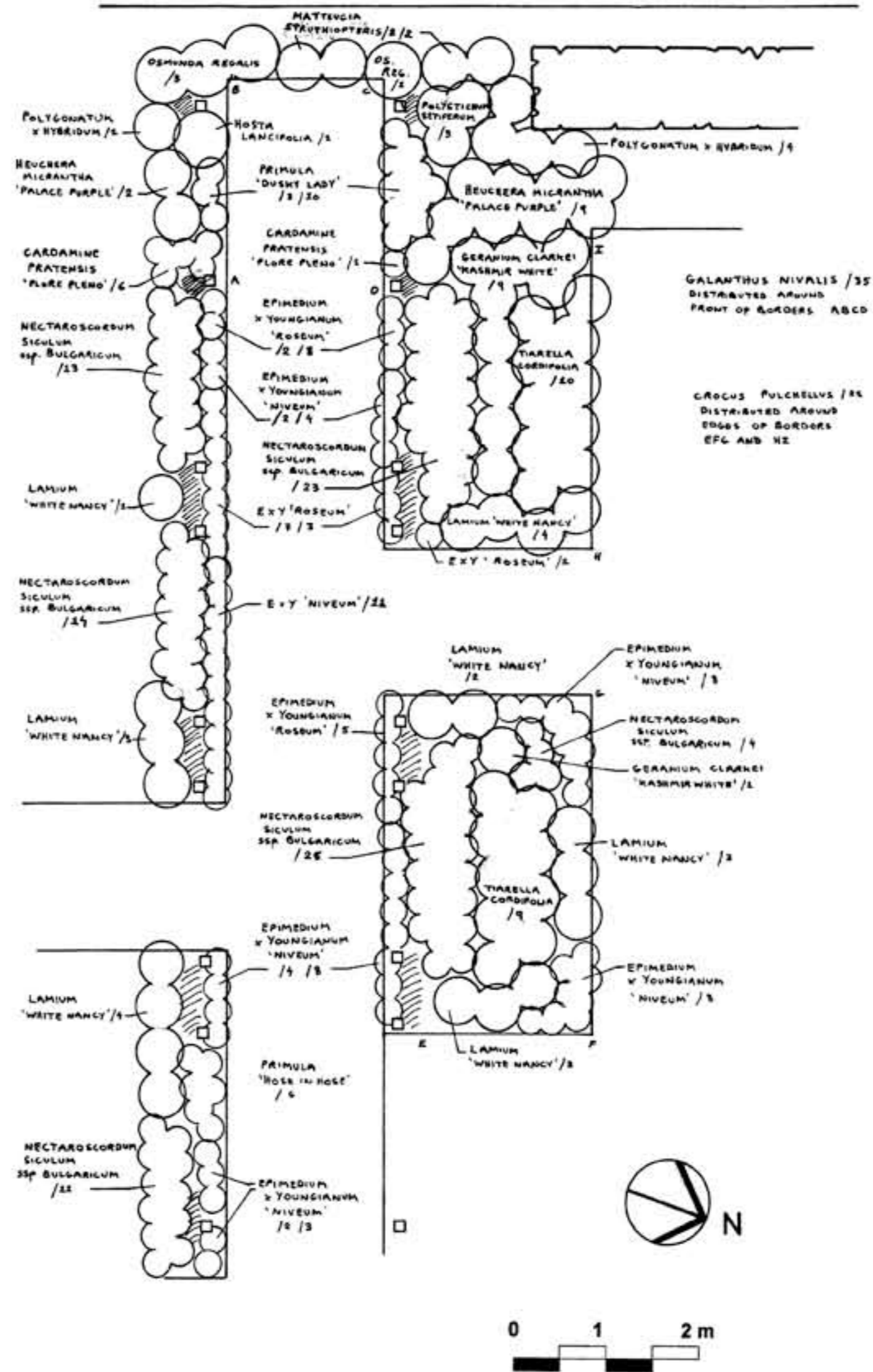

Plants	
Climbers	
Clematis 'Nelly Moser' /1	1
Clematis montana 'Alexander' /1	1
Clematis montana 'Elizabeth' /1	1
Clematis montana 'Marjorie' /1	1
Clematis montana 'Tetrarose' /1	1
Lonicera japonica 'Halliana' /1	1
Parthenocissus henryana /1	1
Hedera helix 'Astropurpurea' /1	1
Rosa 'Alberic Barbier' /1	1
R. 'Gloire de Dijon' /1	1
R. 'Veilchenblau' /1	1
R. 'Felicite et Perpetue' /1	1
R. 'Mme Alfred Carriere' /1	1
R. 'New Dawn' /1	1
R. 'Mme Gregoire Staechelin' /1	1
R. 'May Queen' /1	1
R. 'Danse de Feu' /1	1
R. 'Maigold' /1	1
R. 'Mermaid' /1	1
Herbaceous & Bulbs	
Epimedium x youngianum 'Roseum' /7,2,8,3	20
Epimedium x youngianum 'Niveum' /2,3,4,11,2,4,8,8,8	50
Primula 'Dusky Lady' /3,10	13
Primula 'Rose in Rose' /6	6
Cardamine pratensis 'Flore Pleno' /6	6
Nectaroscordum siculum ssp. bulgaricum /11,14,13,23,24,4	89
Geranium clarkei 'Kashmir White' /9,1,10	10
Lamium 'White Nancy' /4,3,1,4,2,3,3	20
Tiarella cordifolia /10,9	19
Heuchera micrantha 'Palace Purple' /2,9	11
Hosta lancifolia /1	1
Crocus pulchellus /25	25
Galanthus nivalis /35	35
Ferns etc	
Osmunda regalis /3,1	4
Polystichum setiferum /3	3
Matteucia struthiopteris /2,2	4
Polygonatum x hybridum /1,4	5

PLANTING: HERB GARDEN AND CHESTNUT GARDEN (North)

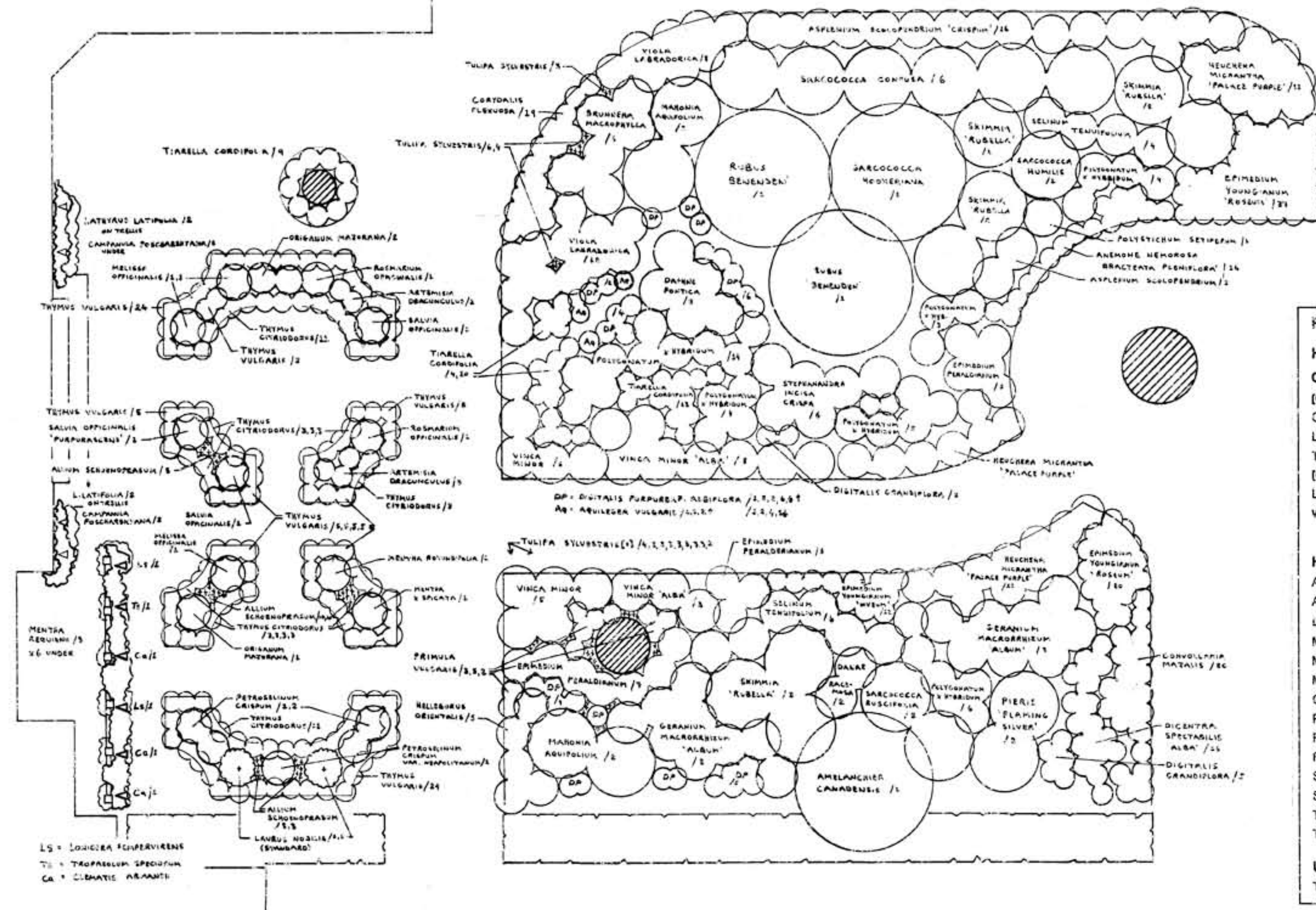
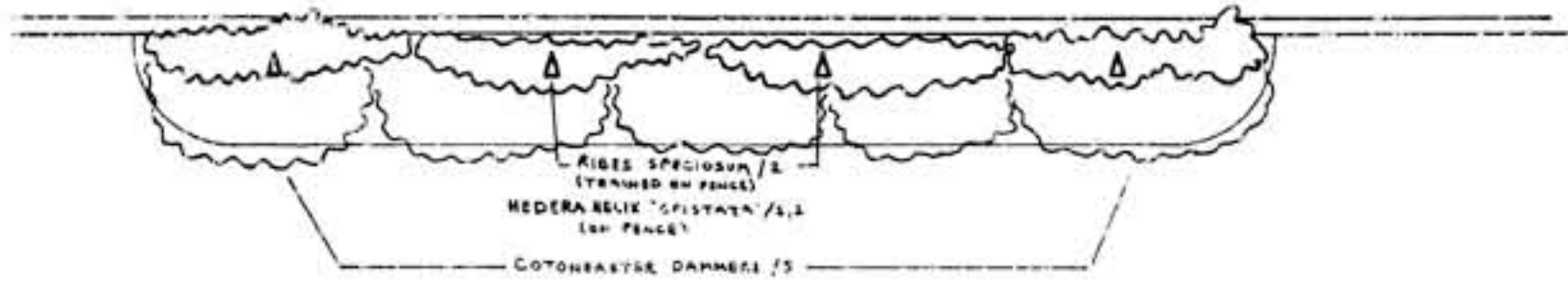

Plants	
Chestnut Garden (North)	
Climbers	
Hedera helix 'Cristata' /1,1	2
Ribes speciosum /2	2
Shrubs	
Cotoneaster dammeri /5	5
Daphne pontica /5	5
Manonia aquifolium /2,2	4
Pieris 'Flaming Silver' /2	2
Rubus 'Benenden' /1,1	2
Sarcococca confusa /6	6
Sarcococca hookeriana /1	1
Sarcococca humilis /1	1
Sarcococca ruscifolia /2	2
Skimmia 'Rubella' /2,1,2,3	8
Stephanandra incisa 'Crispa' /6	6
Vinca minor /5,6	11
Vinca minor 'Alba' /3,8	11
Herbaceous & Bulbs	
Anemone nemorosa	
'Bractea Pleniflora' /16	16
Aquilegia vulgaris /1,1,2	4
Asplenium scolopendrium /2,3	5
A. scolopendrium 'Crispum' /16	16
Brunnera macrophylla /6	6
Convallaria majalis /20	20
Corydalis flexuosa /19	19
Danae racemosa /2	2
Dicentra spectabilis 'Alba' /16	16
Digitalis grandiflora /5,2	7
Digitalis purpurea f. Albiflora /5,6,2,6,2,4,1,2,4,2	35
Epimedium peralidianum /5,3,7	15
Epimedium youngianum 'Niveum' /12	12
E. youngianum 'Roseum' /37,20	57
Geranium macrorrhizum /8,8	16
Helleborus orientalis /5	5
Heuchera micrantha 'Palace Purple' /11,11	22
Polygonatum x hybridum /6,3,5,4	19
Polytachium setiferum /1	1
Primula vulgaris /3,5,2	10
Selinum tenuifolium /4,6	10
Tiarella cordifolia /13,4,10	27
Tulipa sylvestris /13,32	45
Viola labradorica /8,12	20

Plants	
Herb Garden	
Climbers	
[On new Trellis]	
Clematis arandii /3	3
Lonicera sempervirens /2	2
Tropaeolum majus /1	1
[On existing trellis on house wall]	
Lathyrus grandiflorus /2,2	4
With: Campanula poscharskyana /2,2	
[under]	
Herbs	
Allium schoenoprasum /8,8,8,8,8	40
Artemisia dracunculus /2,2	4
Laurus nobilis [as standards] /2	2
Melissa officinalis /2,1	3
Mentha rotundifolia /1	1
Mentha x spicata /1	1
Origanum majorana /2,1	3
Petroselinum crispum /4	4
P. crispum var. Neapolitanum /1	1
Rosmarium officinalis /1,1	2
Salvia officinalis /1,1	2
S. officinalis 'Purpurescens' /1	1
Thymus vulgaris /24,5,5,5,5,5,5,5,24	88
T. citriodorus /11,3,3,3,3,3,3,3,11	45
Under tree	
Tiarella cordifolia /8	8

